

Operating Guide / Инструкция

AQT DN 10-32

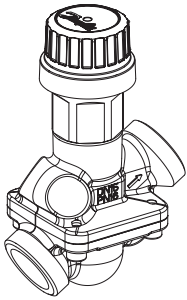

TWA-Z +
AQT DN 10-32

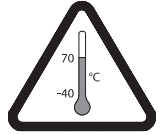
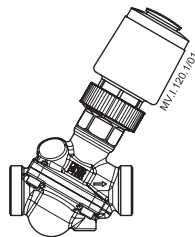

ABNM +
AQT DN 10-32

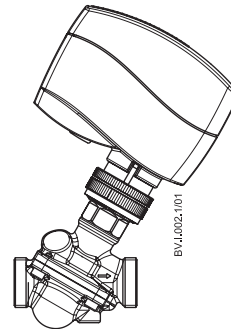

AMV/AME 110 NL, 120 NL +
AQT DN 10-32

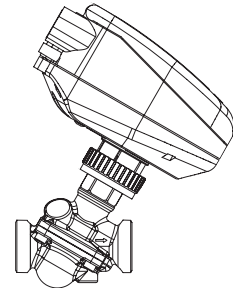

NovoCon™ +
AQT DN 10-32

Installation / Монтаж

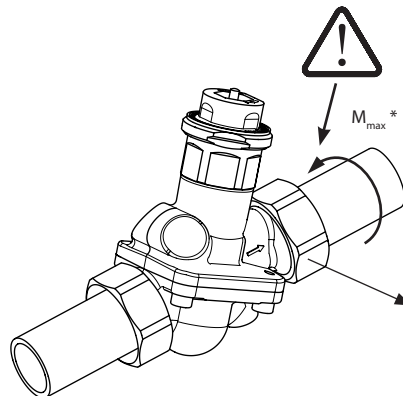
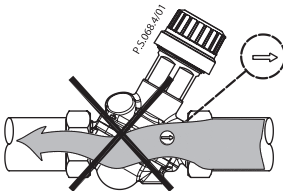
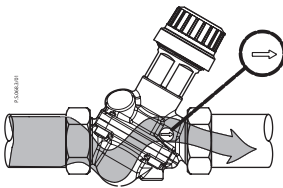

DN	To pipe		Weld.c.		Solder.c.		
	L (mm)	Code No.	L (mm)	Code No.	L (mm)	Code No.	
10	R 3/8	26	003Z0231		17	065Z7016	
15	R 1/2	27.5	003Z0232	37	003Z0226	22	065Z7017
20	R 3/4	30.5	003Z0233	42	003Z0227		
25	R 1	35	003Z0234	42	003Z0228		
32	R 1 1/4	38.5	003Z0235	42	003Z0229		

* M_{max} for DN 10 is 35 Nm

To pipe	Соединение с трубопроводом
Weld.c.	Ниппель под приварку
Solder.c.	Ниппель под пайку

TWA-Z

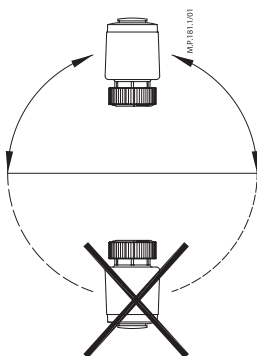

IP 41

ABNM

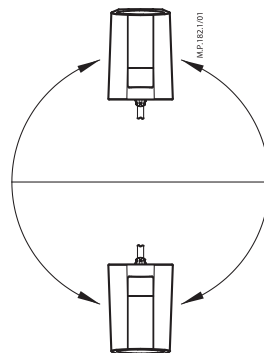

IP 54

AMV/AME 110NL, 120 NL

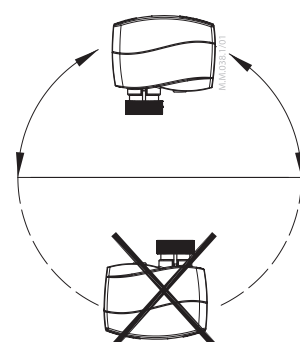

IP 42

AQT DN 10-32

Shut off / Отключение

$\Delta p_{max} = 1 \text{ bar}$

Code No.: **003Z0240**

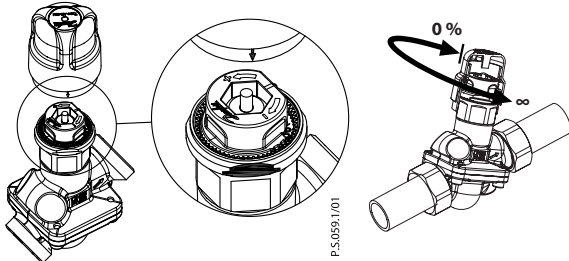

$\Delta p_{max} = 16 \text{ bar}$

Code No.: **003Z1230**

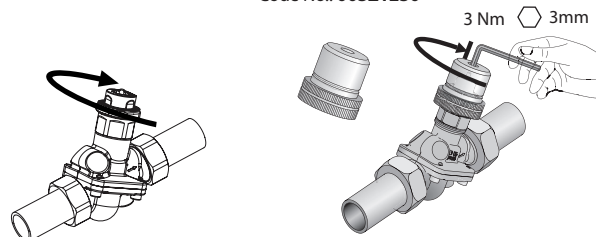

Setting / Настройка

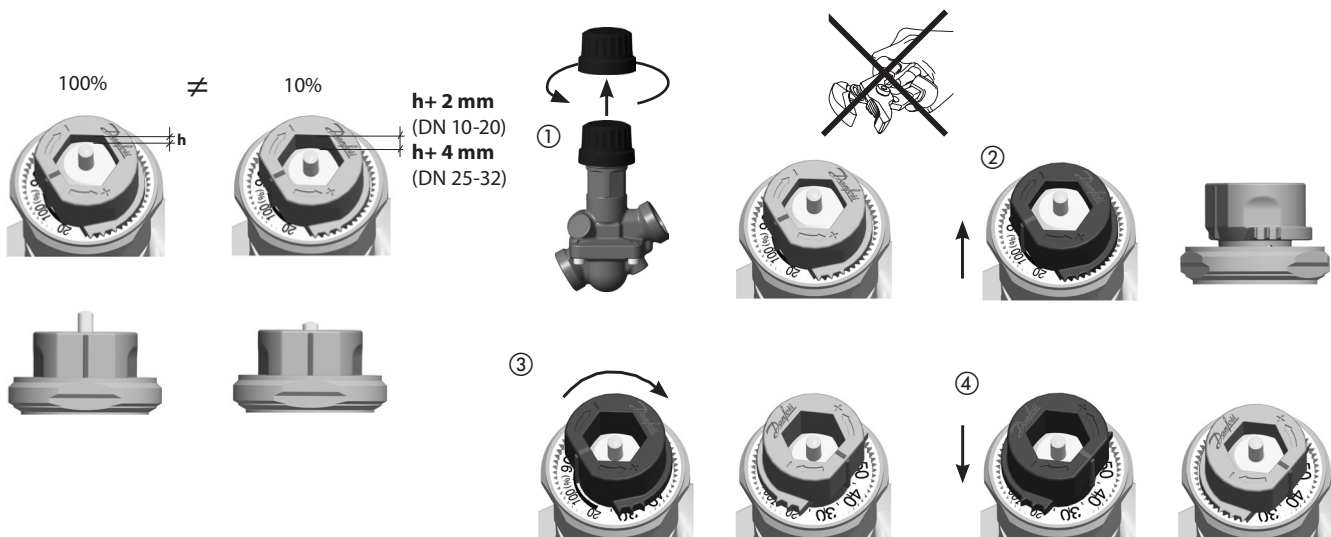

Locking / Блокировка

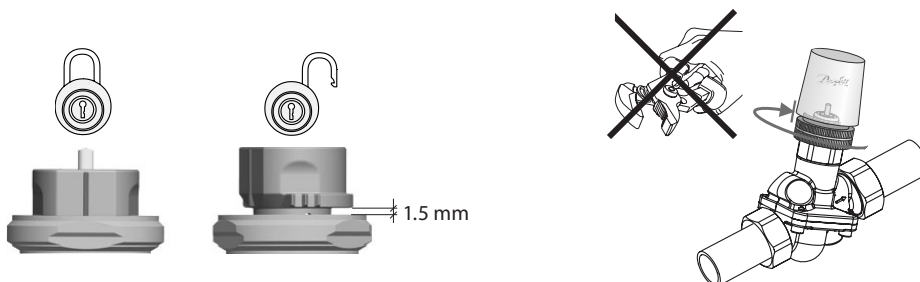

AQT DN 10-32

Measuring / Измерение

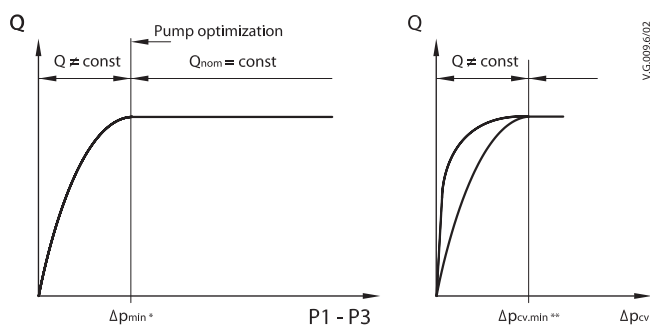
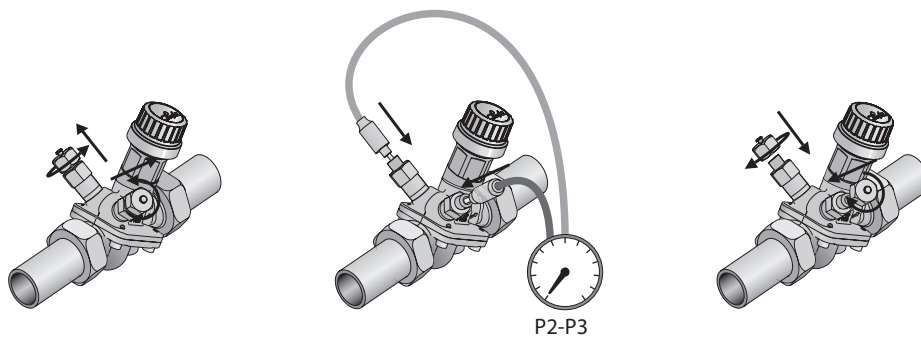

V.G.009.6/02

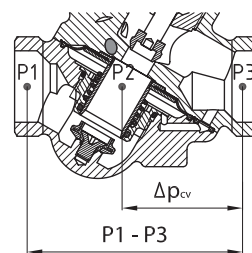

P.C.005.1/01

* $\Delta p_{min} = (P1-P3)_{min}$
 ** $\Delta p_{cv.min} = \Delta p_{cv.min}$



-10...120 °C



PN 16

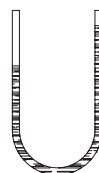

$\Delta p_{max.} = 600 \text{ kPa (6 bar)}$



AQT DN 10-32

DN 10 LF	L/h	L/s	GPM
20%	30	0.008	0.13
25%	38	0.010	0.17
30%	45	0.013	0.20
35%	53	0.015	0.23
40%	60	0.017	0.26
45%	68	0.019	0.30
50%	75	0.021	0.33
55%	83	0.023	0.36
60%	90	0.025	0.40
65%	98	0.027	0.43
70%	105	0.029	0.46
75%	113	0.031	0.50
80%	120	0.033	0.53
85%	128	0.035	0.56
90%	135	0.038	0.59
95%	143	0.040	0.63
100%	150	0.042	0.66
105%	158	0.044	0.69
110%	165	0.046	0.73
115%	173	0.048	0.76
120%	180	0.050	0.79

DN 10	L/h	L/s	GPM
20%	55	0.015	0.24
25%	69	0.019	0.30
30%	83	0.023	0.36
35%	96	0.027	0.42
40%	110	0.031	0.48
45%	124	0.034	0.54
50%	138	0.038	0.61
55%	151	0.042	0.67
60%	165	0.046	0.73
65%	179	0.050	0.79
70%	193	0.053	0.85
75%	206	0.057	0.91
80%	220	0.061	0.97
85%	234	0.065	1.03
90%	248	0.069	1.09
95%	261	0.073	1.15
100%	275	0.076	1.21
105%	289	0.080	1.27
110%	303	0.084	1.33
115%	316	0.088	1.39
120%	330	0.092	1.45

DN 15	Flow / Ном. расход			High Flow / Повыш. расход		
	L/h	L/s	GPM	L/h	L/s	GPM
20%	55	0.015	0.24	227	0.063	1.00
25%	69	0.019	0.30	284	0.079	1.25
30%	83	0.023	0.36	341	0.095	1.50
35%	96	0.027	0.42	397	0.110	1.75
40%	110	0.031	0.48	454	0.126	2.00
45%	124	0.034	0.54	511	0.142	2.25
50%	138	0.038	0.61	568	0.158	2.50
55%	151	0.042	0.67	624	0.173	2.75
60%	165	0.046	0.73	681	0.189	3.00
65%	179	0.050	0.79	738	0.205	3.25
70%	193	0.053	0.85	795	0.221	3.50
75%	206	0.057	0.91	851	0.236	3.75
80%	220	0.061	0.97	908	0.252	4.00
85%	234	0.065	1.03	965	0.268	4.24
90%	248	0.069	1.09	1022	0.284	4.49
95%	261	0.073	1.15	1078	0.300	4.74
100%	275	0.076	1.21	1135	0.315	4.99
105%	289	0.080	1.27	1192	0.331	5.24
110%	303	0.084	1.33	1249	0.347	5.49
115%	316	0.088	1.39	-	-	-
120%	330	0.092	1.45	-	-	-

DN 20	Flow / Ном. расход			High Flow / Повыш. расход		
	L/h	L/s	GPM	L/h	L/s	GPM
20%	180	0.050	0.79	340	0.094	1.50
25%	225	0.063	0.99	425	0.118	1.87
30%	270	0.075	1.19	510	0.142	2.24
35%	315	0.088	1.39	595	0.165	2.62
40%	360	0.100	1.58	680	0.189	2.99
45%	405	0.113	1.78	765	0.213	3.37
50%	450	0.125	1.98	850	0.236	3.74
55%	495	0.138	2.18	935	0.260	4.11
60%	540	0.150	2.38	1020	0.283	4.49
65%	585	0.163	2.57	1105	0.307	4.86
70%	630	0.175	2.77	1190	0.331	5.24
75%	675	0.188	2.97	1275	0.354	5.61
80%	720	0.200	3.17	1360	0.378	5.98
85%	765	0.213	3.37	1445	0.401	6.36
90%	810	0.225	3.56	1530	0.425	6.73
95%	855	0.238	3.76	1615	0.449	7.11
100%	900	0.250	3.96	1700	0.472	7.48
105%	945	0.263	4.16	1785	0.496	7.85
110%	990	0.275	4.36	1870	0.519	8.23
115%	1035	0.288	4.55	-	-	-
120%	1080	0.300	4.75	-	-	-

DN 25	Flow / Ном. расход			High Flow / Повыш. расход		
	L/h	L/s	GPM	L/h	L/s	GPM
20%	340	0.094	1.50	540	0.150	2.38
25%	425	0.118	1.87	675	0.188	2.97
30%	510	0.142	2.24	810	0.225	3.56
35%	595	0.165	2.62	945	0.263	4.16
40%	680	0.189	2.99	1080	0.300	4.75
45%	765	0.213	3.37	1215	0.338	5.35
50%	850	0.236	3.74	1350	0.375	5.94
55%	935	0.260	4.11	1485	0.413	6.53
60%	1020	0.283	4.49	1620	0.450	7.13
65%	1105	0.307	4.86	1755	0.488	7.72
70%	1190	0.331	5.24	1890	0.525	8.32
75%	1275	0.354	5.61	2025	0.563	8.91
80%	1360	0.378	5.98	2160	0.600	9.50
85%	1445	0.401	6.36	2295	0.638	10.10
90%	1530	0.425	6.73	2430	0.675	10.69
95%	1615	0.449	7.11	2565	0.713	11.29
100%	1700	0.472	7.48	2700	0.750	11.88
105%	1785	0.496	7.85	2835	0.788	12.47
110%	1870	0.519	8.23	2970	0.825	13.07

DN 32	Flow / Ном. расход			High Flow / Повыш. расход		
	L/h	L/s	GPM	L/h	L/s	GPM
20%	640	0.178	2.82	800	0.222	3.52
25%	800	0.222	3.52	1000	0.278	4.40
30%	960	0.267	4.22	1200	0.333	5.28
35%	1120	0.311	4.93	1400	0.389	6.16
40%	1280	0.356	5.63	1600	0.444	7.04
45%	1440	0.400	6.34	1800	0.500	7.92
50%	1600	0.444	7.04	2000	0.556	8.80
55%	1760	0.489	7.74	2200	0.611	9.68
60%	1920	0.533	8.45	2400	0.667	10.56
65%	2080	0.578	9.15	2600	0.722	11.44
70%	2240	0.622	9.86	2800	0.778	12.32
75%	2400	0.667	10.56	3000	0.833	13.20
80%	2560	0.711	11.26	3200	0.889	14.08
85%	2720	0.756	11.97	3400	0.944	14.96
90%	2880	0.800	12.67	3600	1.000	15.84
95%	3040	0.844	13.38	3800	1.056	16.72
100%	3200	0.889	14.08	4000	1.111	17.60
105%	3360	0.933	14.78	4200	1.167	18.48
110%	3520	0.978	15.49	4400	1.222	19.36

Danfoss can accept no responsibility for possible errors in catalogues, brochures and other printed material. Danfoss reserves the right to alter its products without notice. This also applies to products already on order provided that such alterations can be made without subsequent changes being necessary in specifications already agreed. All trademarks in this material are property of the respective companies. Danfoss and the Danfoss logotype are trademarks of Danfoss A/S. All rights reserved.